

21 22 23 24

S 83°42' E ~ 100'

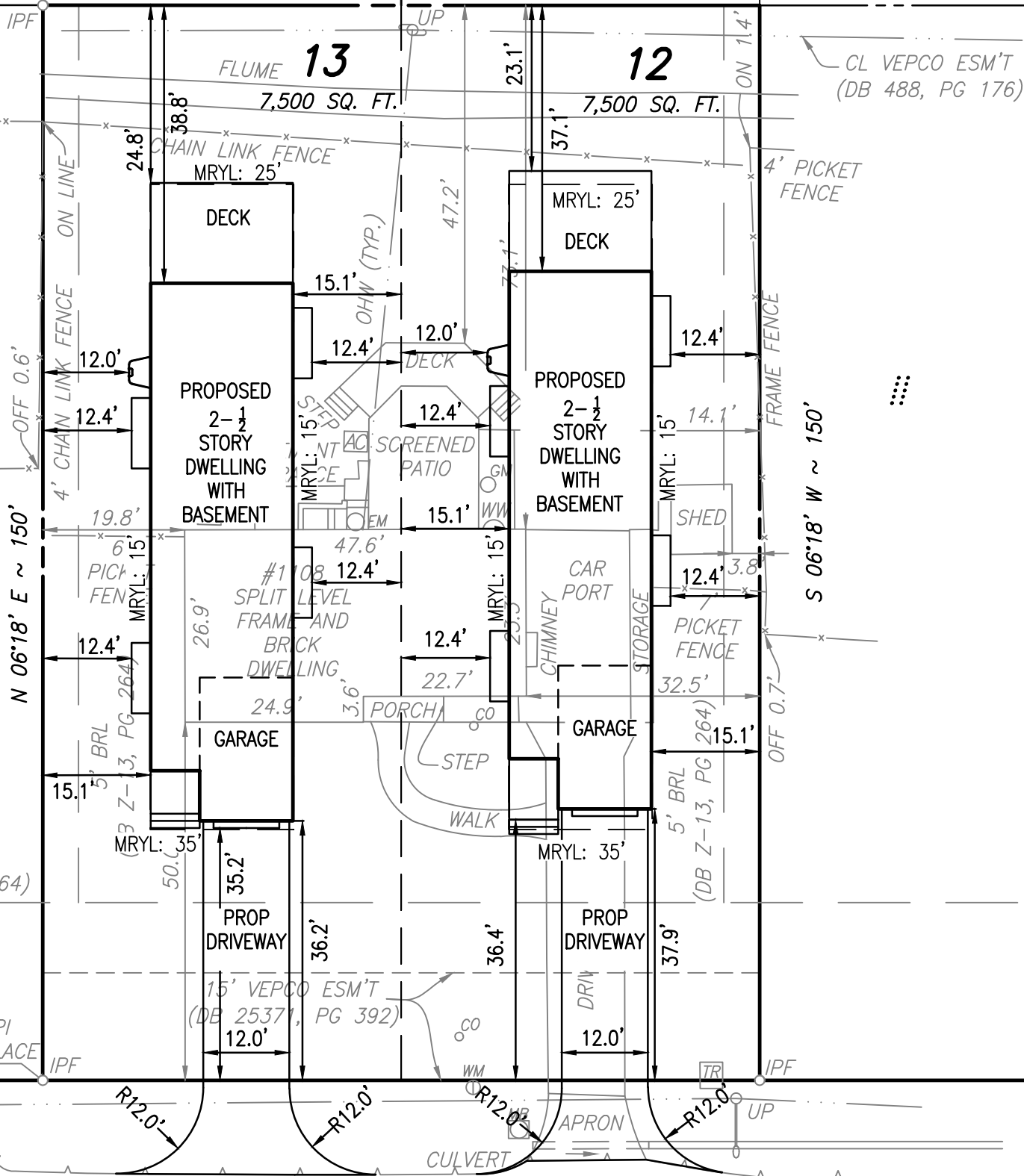

FLUME 13
7,500 SQ. FT.

12
7,500 SQ. FT.

CL VEPCO ESM'T
(DB 488, PG 176)

N 06°18' E ~ 150'

S 06°18' W ~ 150'

N 83°42' W ~ 100'

GLADSTONE PLACE

50' R/W ~ ROUTE #3742
(FORMERLY KNOWN AS COLLINGWOOD AVENUE)

EDGE OF PAVEMENT

EDGE OF PAVEMENT

25' BRL
(DB Z-13, PG 264)

220' TO PI
MARSHALL PLACE

5' BRL
(DB Z-13, PG 264)

R12.0'

R12.0'

R12.0'

R12.0'

EDGE OF PAVEMENT

EDGE OF PAVEMENT