

21 22 23 24

S 83°42' E ~ 100'

SOLD 13

SOLD 12

FLUME
7,500 SQ. FT.

7,500 SQ. FT.

CL VEPCO ESM'T
(DB 488, PG 176)

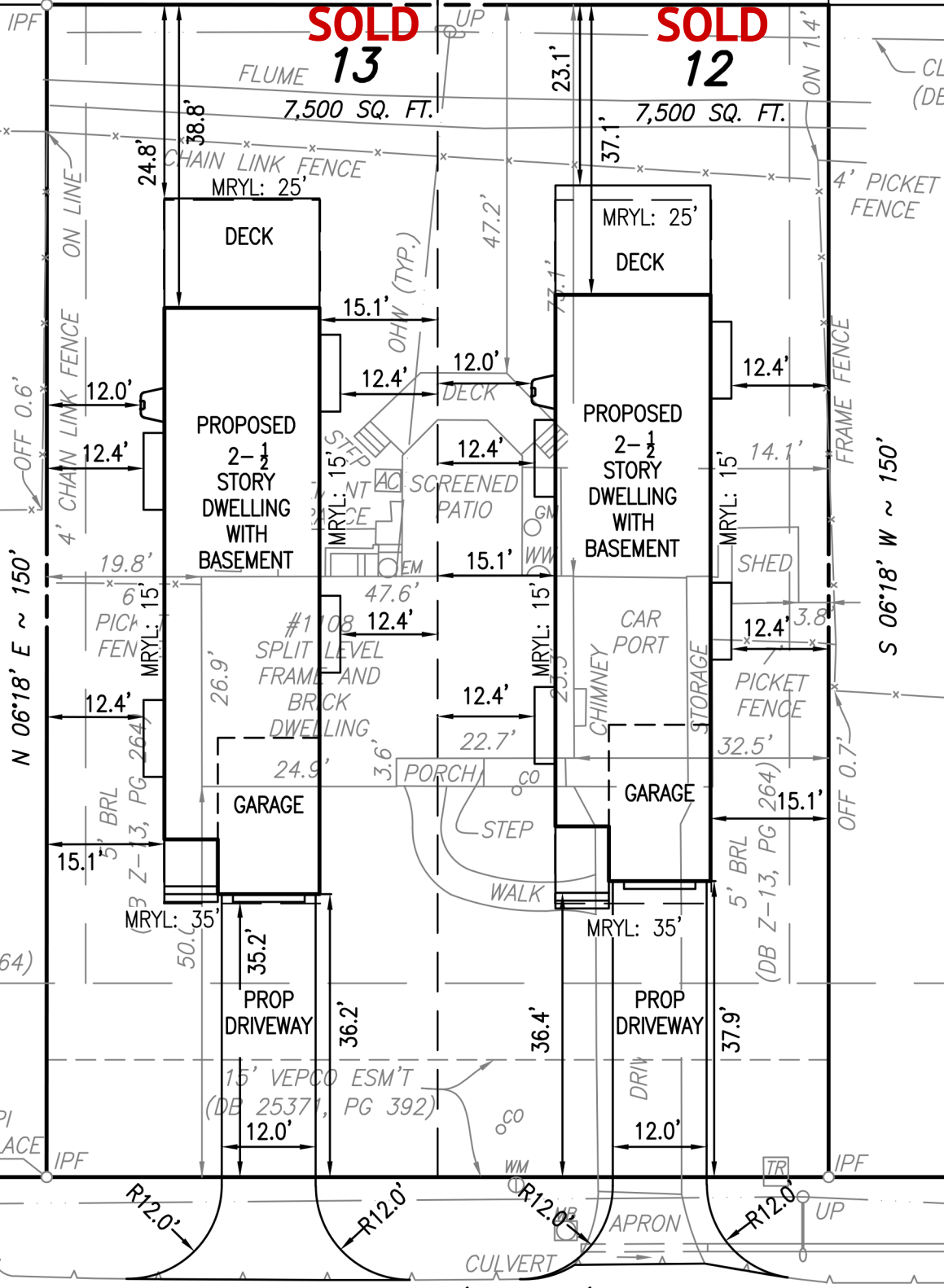

GLADSTONE PLACE

50' R/W ~ ROUTE #3742
(FORMERLY KNOWN AS COLLINGWOOD AVENUE)

25' BRL
(DB Z-13, PG 264)

220' TO PI
MARSHALL PLACE

5' BRL
(DB Z-13, PG 264)

EDGE OF PAVEMENT

EDGE OF PAVEMENT